



IQ Easy LP Static Neutralizing Bar

THE ONE BAR THAT DOES IT ALL

The first of its kind—the IQ Easy LP Bar is engineered to be the “one bar that does it all”. Not only is the IQ Easy LP balanced and optimized for neutralizing on moving webs at close distances, but it also has pulse mode functionality for non-web distance neutralization. It is the one bar that can neutralize in any application. The static bar is equipped with an integrated high-voltage power unit, ion emitters and status LEDs. Input power for the IQ Easy LP is a 24 VDC connection through a 5-pin M12 electrical connector that also provides digital communication.

- Compact bar with .75" height
- Cleanroom rating up to Class 1000 (ISO 6)
- Built in 24 VDC Power Supply
- Capable of neutralizing on moving web speeds exceeding 1600 fpm (optimized for 2" mounting distance)
- Pulse mode for slow moving or stationary targets at wider operating distance
- Balanced Ionization
- Available in lengths from 9.5" to 85"

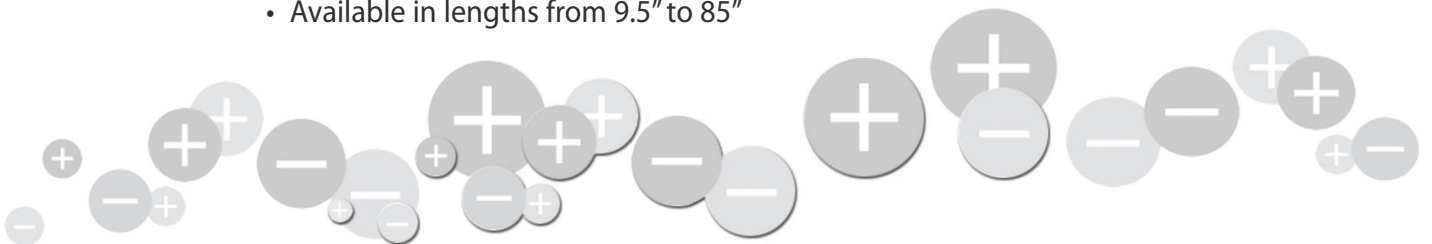

Input Voltage	24 VDC
Input Current	0.75A (max)
Input Connection	5-pin M12 (A-coded) male receptacle
Output Voltage	6 kV
Output Current	30 µA per emitter (max) to ground
Indicators (2)	Green (steady) = Operation Green (flashing) = Standby Green (flickering) = Communication Red (steady) = Fault Red (blinking) = Communication Failure
Intended Use	Industrial, indoor use only
Ingress Protection Class	IP66
Operating Env.	131°F [55°C] (max); 70% RH, no dewing permissible (max)
Target Material Speed	>1600 fpm [488 m/min] (distant dependent)
Operating Distance	1-5" [25-125 mm]
Dimensions	1.34" x 9.45-85.04" x 0.75" [34 x 240-2160 x 19.1 mm]
Enclosure	Glass fiber reinforced polycarbonate
Compliance	RoHS Compliant, ETL Approved

The 24 VDC supply voltage is converted inside the static neutralizing bar into positive and negative high voltage. The high voltage generates an electrical field at the emitters of the static bar, which causes the air molecules around the emitters to be converted into positive and negative ions. When an electrostatically charged material comes within operating distance of the static bar, ions from the static bar are exchanged with the charged material until the material is neutralized.

Control Station

Leverage the full power of the IQ Easy LP with the IQ Power Control Station. The Control Station is the central monitoring device of the IQ Power system and features a user-friendly interface to help you monitor and control up to 10 neutralizers or sensing devices and operate in 6 different modes. The Control Station allows for closed-loop feedback (CLFB) adjustments which offers the most precise static control and lowest residual charge levels.

Parts and Accessories

Item	Part No.
M12 to M12 Cables for connecting Static Bar to Control Station with straight connector at bar end	
1.5 meter (4.9 foot)	5051939
5 meter (16.4 foot)	5051791
10 meter (32.8 foot)	5051792
20 meter (65.6 foot)	5051793
30 meter (98.4 foot)	5051794
M12 to RJ-45 Cables for connecting Static Bar to Control Station (1 thru 10) with straight connector at bar end	
4.57 meter (15 foot)	5051840
9.14 meter (30 foot)	5051844
M12 Cables with flying leads for Standalone Mode with straight connector at bar end	
5 meter (16.4 foot)	5051606
10 meter (32.8 foot)	5051737
Connector for Standalone Mode - Provides 500 mm (20 inch) flying leads for user connection (use with M12 to M12 cable)	4612473
AC Adapter for Standalone Mode, does not provide output	
5 meter (16.4 foot) cable w/ straight connector for bar, 120 VAC	5051608
5 meter (16.4 foot) cable w/ straight connector for bar, 230 VAC	5051609
Mounting Kit (includes mounting bracket, perf strip and hardware)	5051918
Static Bar Cleaning Brush	4670204

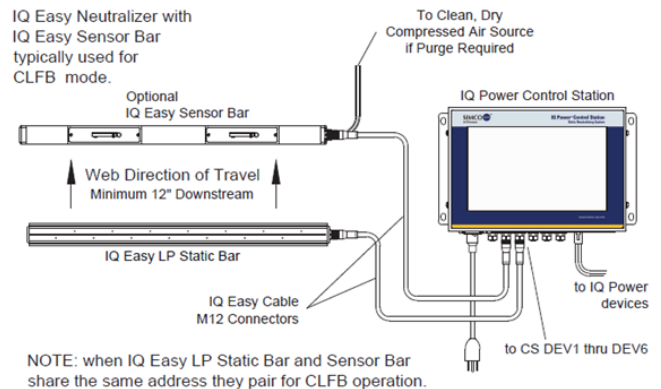

Simco-Ion

2257 North Penn Road
Hatfield, PA 19440-1998
Tel: 800.203.3419 (in USA)
Tel: 215.822.6401

P/N 5201317 Rev. A
© 2020 Simco-Ion – All rights reserved.
Specifications are subject to change without notice.

customerservice@simco-ion.com
www.simco-ion.com